

Bearings are magnetic Distances in metres Elevation in ft AMSL Coordinates WGS 84		AFIS 123.850	AD ELEV 149	ALBENGA/RIVIERA AIRPORT	
			APRON ELEV 152		
RWY	QFU	THR	bearing strength		
09	092°	N 44°03'03.12" E 008°07'10.45"	PCN 52/F/C/X/T		
27	272°	N 44°03'00.88" E 008°08'10.86"			

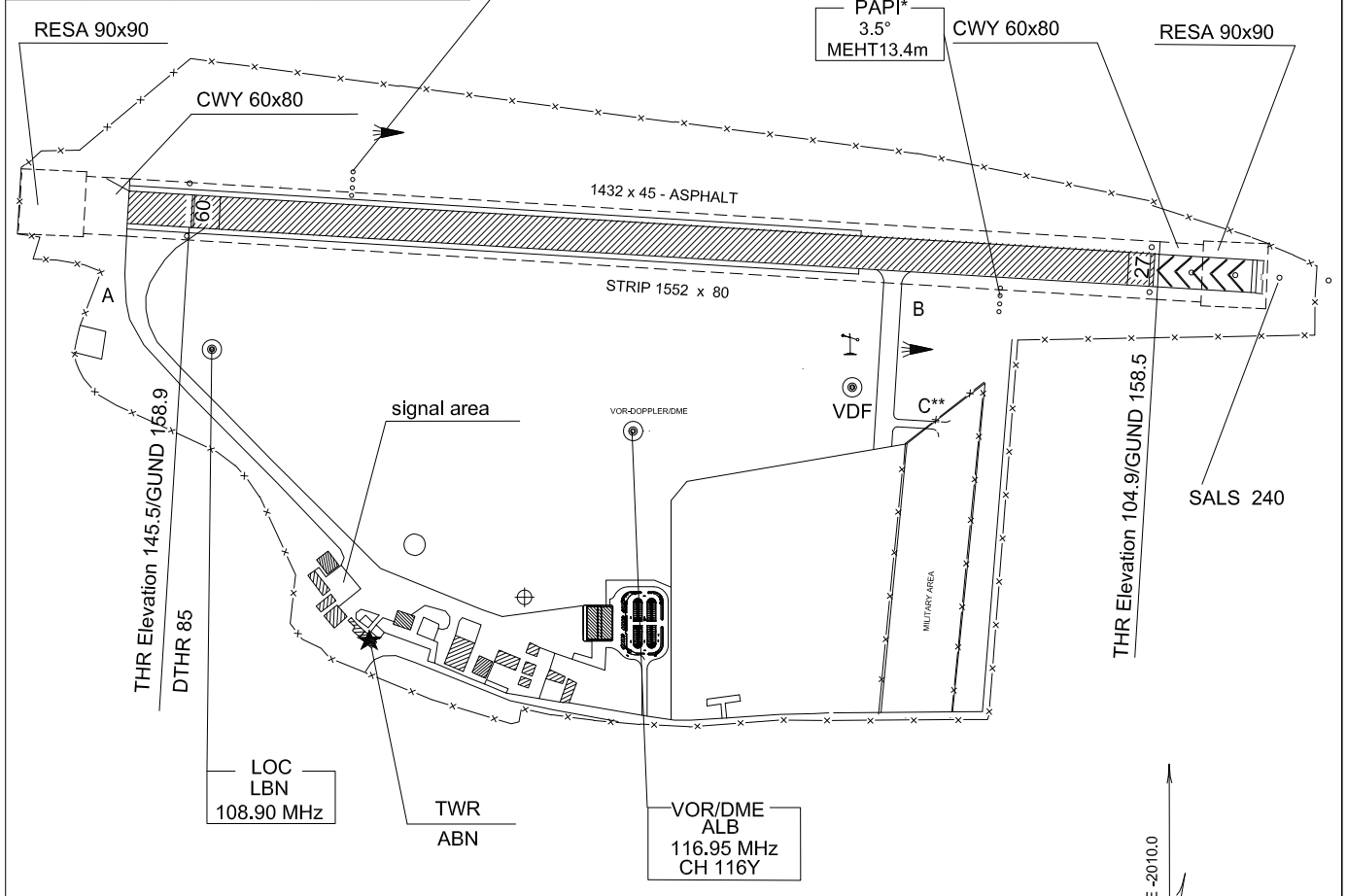

CHANGE: Aerodrome name

TWY IDENT	WIDTH	bearing strength
A	20	PCN 39/F/C/X/T
B	18	PCN 18/F/C/Y/T
C	10	PCN 11/F/C/Y/T

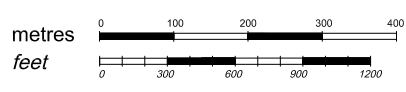

VAR +1° E -2010.0
Annual rate of change 6'E

REMARKS

* System axis displaced 4° North of RCL.
Azimuth spread of the system reduced to 5° at left side of the RCL and 4° at right side RCL.
Obstacle protection surface: non-instrument.

** TWY "C" for military and State aircraft, rescue and fire-fighting services use only.

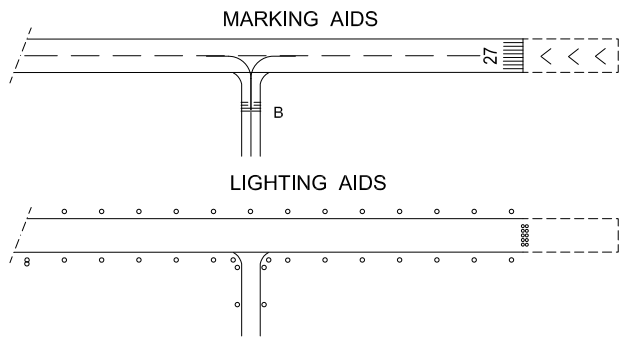
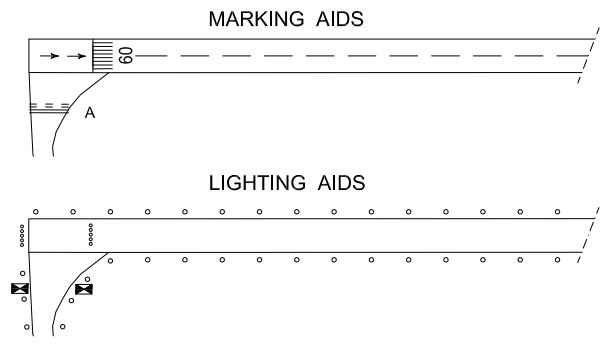

Bearing are magnetic
Distances in metres
Elevation in ft AMSL
Coordinates WGS 84

AFIS
123.850

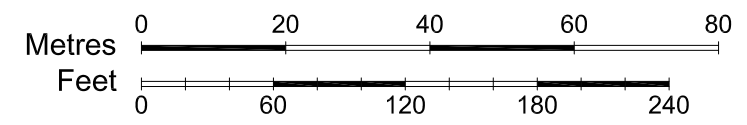

AD ELEV
149
APRON ELEV
152

ALBENGA/RIVIERA AIRPORT

LIMG

44° 02' 45" N

008° 07' 32" E

REMARK: Movements of aircraft with wing span greater than 18m must be conducted only with Marshall car assistance.

CIVIL APRON

LIGHTING BEARING STRENGTH

Edge: NIL

Apron 1
Surface: 5000 m² Asphalt
Strength: PCN 47/F/C/X/T

Apron 2
Surface: 5000 m² Concrete
Strength: PCN120/R/B/X/T

Apron 3
Surface: 5000 m² Grass
Strength: 5 SIWL

Apron 4
Surface: 9300 m² Grass
Strength: 5 SIWL

POINTS OF PARKING AREA

STANDS	N	E
21	44° 02' 43.68"	008° 07' 31.75"
22	44° 02' 43.92"	008° 07' 33.07"
23	44° 02' 44.17"	008° 07' 34.39"

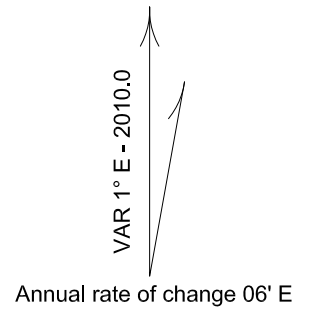

CHANGE: Aerodrome name

